

RECEIVED

JUL 17 1972

TAX COM. *copy made*

ORDINANCE NO. 531

AN ORDINANCE ANNEXING CERTAIN LANDS TO THE CITY OF REXBURG, IDAHO; DESCRIBING SAID LANDS AND DECLARING SAME A PART OF THE CITY OF REXBURG, IDAHO; AND AMENDING AND CHANGING THE ZONING MAP OF THE CITY OF REXBURG, IDAHO, TO SHOW SUCH ANNEXATION AND THE CLASSIFICATION OF THE SAME UNDER THE ZONING ORDINANCE OF THE CITY OF REXBURG, IDAHO.

WHEREAS, the land hereinafter described is contiguous and adjacent to the City of Rexburg and the owner or proprietor, or by his authority, has sold or begun to sell off such contiguous and adjacent lands by meets and bounds in tracts not exceeding five acres, and

WHEREAS, it appears to the Mayor and City Council of the City of Rexburg, Idaho, that the hereinafter described property is subject to annexation to the City of Rexburg under and pursuant to the provisions of Section 50-222, Idaho Code, and that said land should be annexed to and become a part of the City of Rexburg, Idaho, and

WHEREAS, the City Council referred the zoning of the affected territory for report and recommendations to the Zoning Commission (City Planning Board); that after due hearing as provided by Section 50-1206, Idaho Code, the Zoning Commission made its report and recommendations for zoning classification of the hereinafter described property proposed to be annexed, and

WHEREAS, the Council has determined that the proper classification under the Zoning Ordinance of the City of Rexburg, Idaho, for each piece of property to be annexed is as hereinafter set forth.

NOW, THEREFORE, BE IT ORDAINED BY THE MAYOR AND CITY COUNCIL OF THE CITY OF REXBURG, AS FOLLOWS:

SECTION I. That the following described land situated in Madison County, Idaho, to-wit:

Commencing at the Southwest corner of the Northwest Quarter of Section 20, Township 6 North, Range 40 East, Boise Meridian, in Madison County, State of Idaho, which point is further identified as located on the North boundary line of the Rexburg City limits and running thence East 1518 feet; thence North 630 feet, more or less, to the South bank of the South Fork of the Teton River; thence Westerly, following the meandering line of said river bank, a distance of 1595 feet, more or less, to the West line of said Section 20, at a point approximately 634.7 feet North of the point of beginning; thence South along said section line 279.7 feet; thence West 525 feet into Section 19, Township and Range aforesaid; thence North 277.27 feet to the South boundary line of the Teton River Flood Control Project right-of-way; thence North 88°05' West 894 feet, more or less, to the East line of the Union Pacific Railroad right-of-way; thence South 30°23' West along said right-of-way line a distance of 693 feet, more or less, to the said North boundary line of the Rexburg City limits; thence East 1865.5 feet, more or less, to the point of beginning.

Classified under the zoning ordinance of the City of Rexburg as C1.

Commencing at a point that is 2,640 feet East of the N.W. corner of Section 29, Township 6 North, Range 40 E.B.M., said point being on the easterly corporate limits of the City of Rexburg, Madison County, Idaho, and running thence South along said corporate limit line a distance of 1,534.5 feet to the centerline of Second South Street; thence East 200.0 feet; thence North 1,534.5 feet; thence West 200.0 feet to the point of beginning.

Classified under the zoning ordinance of the City of Rexburg as R1.

Commencing at a point 49.5 feet West of the Southeast corner of Section 25, Township 6 North, Range 39 E.B.M., in Madison County, State of Idaho, and running thence West approximately 1075 feet to the East line of U.S. Highway No. 191-20; thence North 30°25' East along said highway line approximately 2150 feet to the West line of South Fifth West Street; thence South 1855 feet, more or less, to the point of beginning.

Classified under the zoning ordinance of the City of Rexburg as C1.

shall be, and the same hereby is annexed to the City of Rexburg, and shall be, and hereby declared to be, a part of the City of Rexburg, Idaho.

SECTION II: That the above described property hereby annexed to the City of Rexburg be, and the same is hereby classified under the Zoning Ordinance of the City of Rexburg as

above set forth; that the new zoning map shall be amended to show this annexation and classification of the above-described property so annexed and that said amendment shall be certified to and declared to be the official zoning map of the City of Rexburg by a certificate of the Mayor and Council of the City of Rexburg endorsed thereon.

SECTION III: This ordinance shall be in full force and effect from and after its passage, approval, due publication and filing of a certified copy thereof with the County Recorder of Madison County, Idaho, as provided by law.

PASSED BY THE CITY COUNCIL OF THE CITY OF REXBURG, IDAHO, this 21st day of June, 1972.

APPROVED BY THE MAYOR this 21st day of June, 1972.

/s/ Henry Shirley
Mayor.

ATTEST:

/s/ Beulah Johnson
City Clerk.

STATE OF IDAHO,)
 ss.
County of Madison.)

I, Beulah Johnson, City Clerk of the City of Rexburg, Idaho, do hereby certify: That the foregoing is a full, true and correct copy of an ordinance entitled:

"AN ORDINANCE ANNEXING CERTAIN LANDS TO THE CITY OF REXBURG, IDAHO: DESCRIBING SAID LANDS AND DECLARING SAME A PART OF THE CITY OF REXBURG, IDAHO: AND AMENDING AND CHANGING THE ZONING MAP OF THE CITY OF REXBURG, IDAHO, TO SHOW SUCH ANNEXATION AND THE CLASSIFICATION OF THE SAME UNDER THE ZONING ORDINANCE OF THE CITY OF REXBURG, IDAHO."

passed by the City Council of the said City and approved by the Mayor on the 21st day of June, 1972.

IN WITNESS WHEREOF, I have hereunto set my hand and affixed the seal of said City of Rexburg, this 21st day of June, 1972.

Beulah Johnson
/s/ Beulah Johnson
City Clerk

(Seal)

531

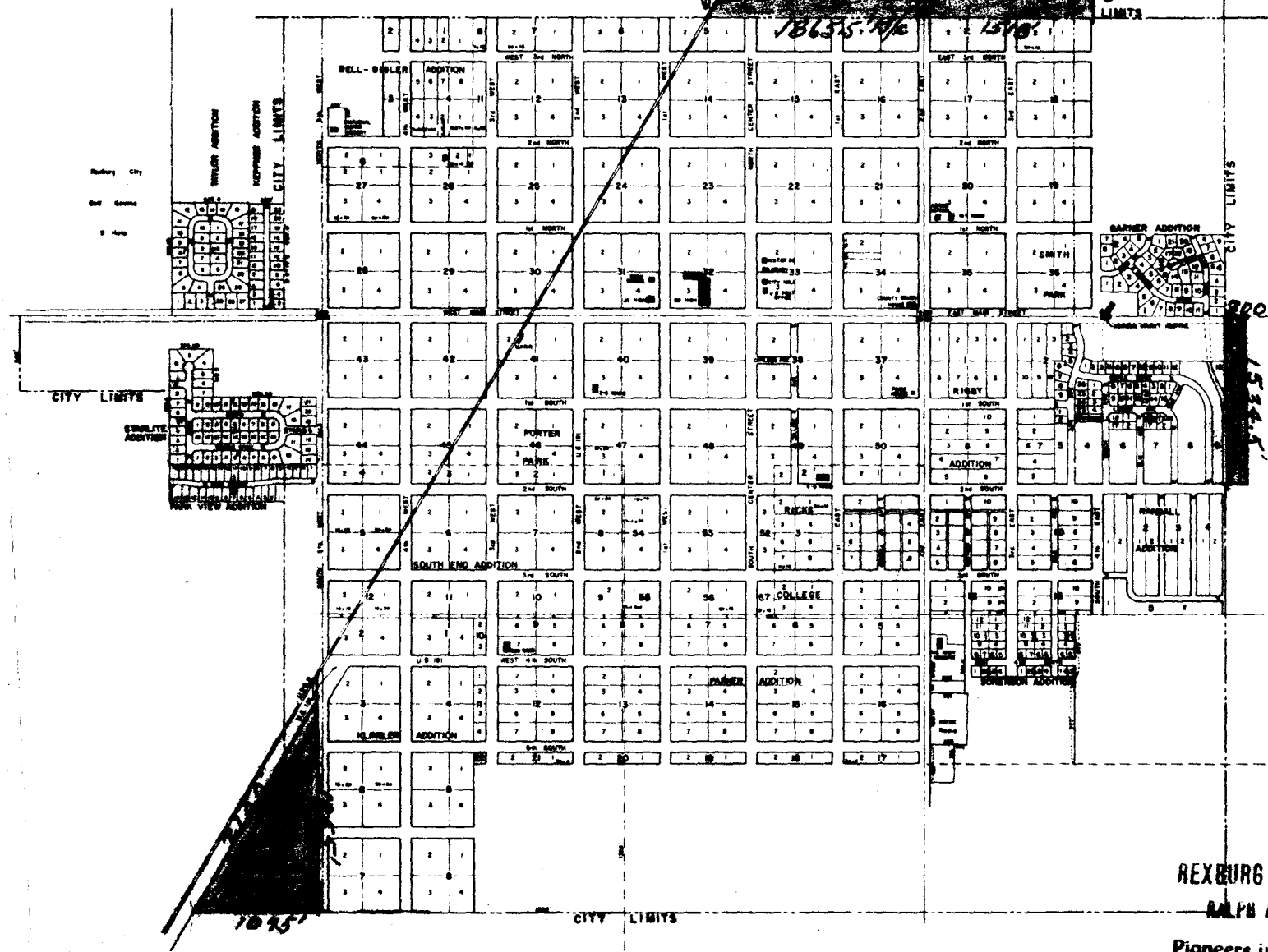

CITY OF
REXBURG
 MADISON COUNTY, IDAHO
 TOWN RACE S.W.
 CLAYTON F. PENDERGAST, REG.
 REXBURG, IDAHO

REXBURG ABSTRACT COMPANY
 RALPH A. PARKER, Secy.-Treas.
 Pioneers in Land Title Insurance

NOTE:
 All streets 50 feet
 wide, except
 1st Street 96.5'
 Main St. 136'
 Others as noted